



# HiPace 800 M

## Turbopump

# Operating Instructions

# Table of contents

<b>1</b>	<b>About this manual</b> . . . . .	<b>3</b>
1.1	Validity . . . . .	3
1.2	Conventions . . . . .	3
<b>2</b>	<b>Safety</b> . . . . .	<b>5</b>
2.1	Safety precautions . . . . .	5
2.2	Protective equipment . . . . .	6
2.3	Proper use . . . . .	6
2.4	Improper use . . . . .	7
<b>3</b>	<b>Transport and storage</b> . . . . .	<b>8</b>
3.1	Transport . . . . .	8
3.2	Storage . . . . .	8
<b>4</b>	<b>Product description</b> . . . . .	<b>9</b>
4.1	Product identification . . . . .	9
4.2	Function . . . . .	10
4.3	Range of application . . . . .	11
<b>5</b>	<b>Installation</b> . . . . .	<b>12</b>
5.1	Set-up . . . . .	12
5.2	Preparatory work . . . . .	12
5.3	Assembly . . . . .	12
5.4	Connections to the turbopump . . . . .	16
<b>6</b>	<b>Operation</b> . . . . .	<b>23</b>
6.1	Commissioning . . . . .	23
6.2	Operation modes . . . . .	24
6.3	Function description . . . . .	24
6.4	Monitoring of the operation conditions . . . . .	24
6.5	Switching off and venting . . . . .	25
<b>7</b>	<b>Maintenance / replacement</b> . . . . .	<b>27</b>
7.1	Maintenance intervals and responsibilities . . . . .	27
7.2	Replacing the electronic drive unit . . . . .	27
<b>8</b>	<b>Decommissioning</b> . . . . .	<b>29</b>
8.1	Shutting down for longer periods . . . . .	29
8.2	Re-starting . . . . .	29
8.3	Disposal . . . . .	29
<b>9</b>	<b>Malfunctions</b> . . . . .	<b>30</b>
9.1	Rectifying malfunctions . . . . .	30
<b>10</b>	<b>Service</b> . . . . .	<b>31</b>
<b>11</b>	<b>Spare parts HiPace 800 M</b> . . . . .	<b>32</b>
<b>12</b>	<b>Accessories</b> . . . . .	<b>33</b>
<b>13</b>	<b>Technical data and dimensions</b> . . . . .	<b>35</b>
13.1	General . . . . .	35
13	Technical data and dimensions . . . . .	35
13.3	Dimensions . . . . .	37
	<b>Declaration of conformity</b> . . . . .	<b>38</b>

# 1 About this manual

## 1.1 Validity

This operating manual is for customers of Pfeiffer Vacuum. It describes the functioning of the designated product and provides the most important information for safe use of the unit. The description follows applicable EU guidelines. All information provided in this operating manual refer to the current state of the product's development. The documentation remains valid as long as the customer does not make any changes to the product.

Up-to-date operating instructions can also be downloaded from [www.pfeiffer-vacuum.com](http://www.pfeiffer-vacuum.com).

### Applicable documents

HiPace 800 M	Operating instructions
Operating instructions "Electronic drive unit TM 700"	PT 0329 BN*
Declaration of conformity	Part of this document

\*also available via [www.pfeiffer-vacuum.com](http://www.pfeiffer-vacuum.com)

For information about other certifications, if applicable, please see the signet on the product or:

- [www.tuvdotcom.com](http://www.tuvdotcom.com)
- TUVdotCOM-ID 0000021320

## 1.2 Conventions

### Safety instructions

The safety instructions in Pfeiffer Vacuum operating manuals are the result of risk evaluations and hazard analyses and are oriented on international certification standards as specified by UL, CSA, ANSI Z-535, SEMI S1, ISO 3864 and DIN 4844. In this document, the following hazard levels and information are considered:

<b>DANGER</b>
<p><b>Immediate danger</b> Death or very severe injuries can occur.</p>
<b>WARNING</b>
<p><b>Possible danger</b> Injuries or severe property damages can occur.</p>
<b>CAUTION</b>
<p><b>Possible danger</b> Injuries or property damages can occur.</p>
<b>NOTE</b>
<p><b>Command or note</b> Command to perform an action or information about properties, the disregarding of which may result in damage to the product.</p>

## Pictograph definitions



Prohibition of an action or activity in connection with a source of danger, the disregarding of which may result in serious accidents.



Warning of a displayed source of danger in connection with operation of the unit or equipment.



Command to perform an action or task associated with a source of danger, the disregarding of which may result in serious accidents.

## Instructions in the text

→ Work instruction: here you have to do something.

## Abbreviations used

**DCU:** Display and operating unit

**HPU:** Handheld programming unit

**TM:** Electronic drive unit and magnetic bearing controller for turbopump

**TPS:** Mains pack

## Symbols used

The following symbols are used consistently throughout the diagrams:

- Ⓜ High vacuum flange
- Ⓦ Fore-vacuum flange
- ⚡ Electric connection
- ⊗ Cooling water connection
- ⓕ Venting connection
- Ⓢ Sealing gas connection

## 2 Safety

### 2.1 Safety precautions



#### NOTE

##### Duty to inform

Each person involved in the installation, operation or maintenance of the vacuum pump must read and observe the safety-related parts of these operating instructions.

→ The operator is obligated to make operating personnel aware of dangers originating from the vacuum pump, the pumped medium and the entire system.



#### NOTE

##### Installation and operation of accessories

Pfeiffer Vacuum pumps can be equipped with a series of adapted accessories. The installation, operation and maintenance of connected devices are described in detail in the operating instructions of the individual components.

→ For information on order numbers of components, see "Accessories".  
→ Use original accessory parts only.



#### NOTE

##### Checking the safety system against excess rotation speed

To provide the functioning of the integrated safety system for avoiding excess rotation speed, the pump must run-up from the standstill at least once a year.

→ Switch off the pump and await the complete standstill (rotation speed = 0 Hz).  
→ Run-up the pump according to this operating instructions.



#### WARNING

##### Danger - Electrical installation

Safe operation after installation is the responsibility of the operator.

→ Do not independently modify or change the pump and electrical equipment.  
→ Make sure that the system is integrated in an emergency off safety circuit.  
→ Consult Pfeiffer Vacuum for special requirements.



#### WARNING

##### Danger of electric shock

In case of defect, the parts connected to the mains supply are under voltage.

→ Always keep the mains connection freely accessible so you can disconnect it at any time.

- Do not expose any body parts to the vacuum.
- Observe all safety and accident prevention regulations.
- Regularly check the proper observance of all safety measures.
- **Power supply:** The turbopump power supply must apply to the requirements of double insulation between mains input voltage and operating voltage according to the regulations of IEC 61010 and IEC 60950. Therefore Pfeiffer Vacuum recommends to use exclusively original-power packs and -accessories. Only in this case Pfeiffer Vacuum is able to guarantee the compliance of the European and North American guidelines.
- A safe connection to the protective earthing conductor (PE) is recommended (protection class III).
- Do not loosen any plug connection during operations.
- Wait for the rotor to reach standstill before performing work on the high vacuum flange.

- Keep leads and cables well away from hot surfaces (> 70 °C).
- Never fill or operate turbopump with cleaning agent.
- Do not operate the turbopump with open high vacuum flange.
- Do not carry out any unauthorized modifications or conversions to the pump.
- When returning the turbopump observe the shipping instructions.

## 2.2 Protective equipment

Determined situations concerning the handling of vacuum pumps require wearing of personal protective equipment. The owner, respectively the employer are obligated to provide adequate equipment to any operating persons.



<b>DANGER</b>
<p><b>Danger to health by hazardous substances during maintenance or installation</b></p> <p>Depending on the process vacuum pumps, components or operating fluids can be contaminated by toxic, reactive or radioactive substances.</p> <p>→ Wear adequate protective equipment during maintenance and repairs or in case of reinstallation.</p>



<b>WARNING</b>
<p><b>Risk of injury through falling objects</b></p> <p>When transporting vacuum pumps by hand, there is a danger through loads slipping and falling down.</p> <p>→ Carry small and mid-size vacuum pumps two-handed.</p> <p>→ Carry vacuum pumps &gt; 20 kg by a suitable lifting device.</p> <p>→ Wear safety shoes with steel toe cap according to directive EN 347.</p>



<b>CAUTION</b>
<p><b>Risk of injury through hot surfaces</b></p> <p>Vacuum pumps can become hot during operation.</p> <p>→ Allow the pump to cool before maintenance and repairs.</p> <p>→ If necessary wear protective gloves according to directive EN 420.</p>



<b>CAUTION</b>
<p><b>Risk of injury through sharp edges</b></p> <p>Rotor and stator disks of turbopumps have very sharp edges.</p> <p>→ Before any working wait for the complete standstill of the pump.</p> <p>→ Do not reach in the high vacuum flange.</p> <p>→ If necessary wear protective gloves according directive EN 420.</p>

## 2.3 Proper use



<b>NOTE</b>
<p><b>CE conformity</b></p> <p>The manufacturer's declaration of conformity becomes invalid if the operator modifies the original product or installs additional components.</p> <p>→ Following installation into a plant and before commissioning, the operator must check the entire system for compliance with the valid EU directives and reassess it accordingly.</p>

- The vacuum pump may only be used to generate a vacuum.
- Only operate the turbopump with an approved backing pump.

## 2.4 Improper use

Improper use will cause all claims for liability and warranties to be forfeited. Improper use is deemed to be all use for purposes deviating from those mentioned above, especially:

- Pumping of corrosive or explosive media.
- Pumping of condensing vapors.
- Pumping of liquids.
- Pumping of dusts.
- Operation with improper high gas throughput.
- Operation with improper high fore-vacuum pressures.
- Operation with improper gas mode.
- Operation with improper high levels of insulated heat input.
- Venting with improper high venting rates.
- Use of the vacuum pump to generate pressure.
- The operation of the devices in potentially radioactive areas.
- Operation in potentially explosive areas.
- The operation of the devices in systems where the turbopumps are subjected to impact-like stress and vibrations or the effect of periodically occurring forces.
- The use of accessories or spare parts, which are not named in this manual.

warranty seal

**PFEIFFER**  **VACUUM**

### NOTE

#### Closure seal

The product is sealed at the factory. Damaging or removal of a closure seal leads to the loss of liability and warranty entitlements.

→ Do not open the product within its warranty period!

→ For process-related shorter maintenance intervals please contact the Pfeiffer Vacuum Service.

## 3 Transport and storage

### 3.1 Transport

- Reuse the transport container. Vacuum pumps should be transported or shipped in the original packing only.
- Only remove the protective covers from the high vacuum and the fore-vacuum side immediately before connection.
- Keep the original protective covers.
- Always transport the turbopump in an upright position.

### 3.2 Storage

- Close the flange openings by using the original protective covers.
- Close further connection ports by using the corresponding protective covers.
- Store the pump only indoors at temperatures between -25 °C and +55 °C.
- In rooms with moist or aggressive atmospheres, the pump must be airproof shrink-wrapped in a plastic bag together with a bag of desiccant.



## 4 Product description

### 4.1 Product identification

#### Pump types

The product designation consists of a family designation (1), the size (2), which is oriented on the pumping speed, and if applicable the additional properties (3) of the pump.

HiPace<sup>(1)</sup> 800<sup>(2)</sup> M<sup>(3)</sup>

1. Family designation	2. Model designation	3. Property designation
HiPace	<b>800</b> = Model designation of the pump related to its pumping speed class	<b>none</b> = Standard version <b>U</b> = Upside-down installation orientation <b>C</b> = Corrosive gas version <b>P</b> = Process <b>M</b> = Active magnetic bearing <b>T</b> = Temperature management system

#### Pump features

Characteristics	HiPace 800 M		
HV flange	DN 200 ISO-K	DN 200 ISO-F	DN 200 CF-F
Flange material	Aluminium	Aluminium	Stainless steel

To correctly identify the product when communicating with Pfeiffer Vacuum, always have the information from the rating plate available.

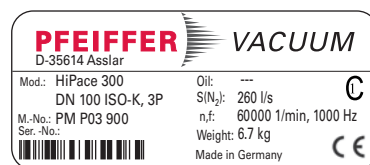

Fig. 1: Example for a rating plate

#### Scope of delivery

- HiPace 800 M with TM 700 and 48 V DC  $\pm$  5 %
- Venting valve PM Z01 291
- Protective cover for the high vacuum and the fore-vacuum flange
- Operating instructions

## 4.2 Function

The turbopump HiPace 800 M forms a complete unit together with the electronic drive and magnetic bearing unit TM 700 (in the following just: "electronic drive unit"). For the voltage supply only Pfeiffer Vacuum power supplies may be used (e.g. TPS or DCU).

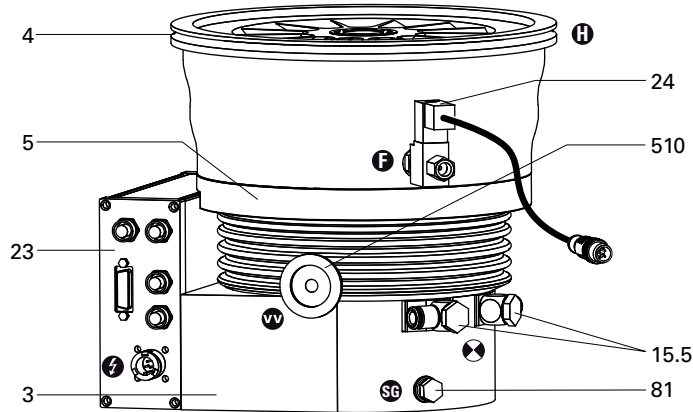

Fig. 2: View of HiPace 800 M with TM 700

3	Pump lower part	15.5	Cooling water connection	81	Sealing gas connection
4	Pump casing	23	Electronic drive unit TM 700	510	Fore-vacuum connection
5	Intermediate piece	24	Venting valve		

### Cooling

- Water cooling
- Air cooling (optional)

In the case of excess temperature the electronic drive unit reduces the drive power automatically. Depending on the application and the HiPace different cooling variants are selectable.

### Rotor bearing

Active-magnetic bearing turbopump

- High vacuum side: electromagnetic radial bearings
- Fore-vacuum side: electromagnetic radial and axial bearings

Active magnetic bearings offer largely wear-free operation and permit lubricant-free vacuum processes. Dry-running safety bearings are installed to avoid contact between the rotor and stator.

### Drive

Electronic drive unit TM 700

### 4.3 Range of application

The pump HiPace 800 M must be installed and operated under the following ambient conditions:

Installation location	weather protected (indoors)
Protection category	IP 54
Protection class	III
Temperature	+5 °C to +35 °C with air cooling +5 °C to +40 °C with water cooling
Relative humidity	max. 50% at T ≤ 40 °C, up to max. 80 %, at T ≤ 31 °C
Atmospheric pressure	75 kPa - 106 kPa
Installation altitude	2000 m max.
Degree of pollution	2
Permissible surr. magnetic field	≤5.5 mT
Overvoltage category	II
Connection voltage electronic drive unit (depending on the variant)	48 V DC ±5%



#### NOTE

##### Remarks to ambient conditions

The denoted permissible ambient temperatures apply to operation of the turbopump at maximum permissible backing pressure or gas throughput depending on the cooling method. The turbopump is intrinsically safe by a redundant temperature monitoring.

- By reducing the backing pressure or gas throughput, the turbopump can be operated at higher ambient temperatures.
- If the maximum permissible operating temperature of the turbopump is exceeded, it reduces drive power first and switches off then, if necessary.

## 5 Installation



### DANGER

#### Danger from the turbopump being torn-off

In case of sudden blocking of the rotor, torques of up to 6500 Nm can occur, which can lead with incorrect attachment to tearing the turbopump off. The energy released thereby can hurl the entire pump or fragments from their inside around the area. This can cause severest injuries (possibly resulting in death) and large property damage.

- Precisely follow installation instructions.
- Only use Pfeiffer Vacuum original components (accessories) for installation.



### NOTE

#### Installation and operation of accessories

Pfeiffer Vacuum pumps can be equipped with a series of adapted accessories. The installation, operation and maintenance of connected devices are described in detail in the operating instructions of the individual components.

- For information on order numbers of components, see "Accessories".
- Use original accessory parts only.

### 5.1 Set-up

When installing the pump, observe the following conditions:

- The ambient conditions specified for the area of use.
- When using a casing heating and a water cooling unit the temperature of the connected flange of the vacuum chamber must not exceed 120 °C.
- It is not allowed to operate the device in systems where impact-like stresses and vibrations or periodically forces occur.

### 5.2 Preparatory work

- Ensure sufficient cooling for the turbopump.
- Where magnetic fields > 5.5 mT are involved, a suitable shielding must be used. Check installation location and consult Pfeiffer Vacuum if needed!
- The maximum permissible rotor temperature for the turbopump is 120 °C. If high temperatures arise for process reasons, the radiated heat input must not exceed 4.2 W. Install suitable screening sheets, if necessary (design information on request).

### 5.3 Assembly



### NOTE

#### Danger due to external vibrations

External pump vibrations may cause magnet bearing overload and therefore safety bearing stress.

- Avoid lateral and tilting pump movements.
- Configure the system appropriately to compensate for external vibration, e.g. due to high-vacuum valves.
- Secure the vacuum chamber provided by the customer against moving and tilting.

- Ensure the greatest possible cleanliness when installing any high vacuum parts. Unclean components prolong the pump-down time.
- All flange components must be grease-free, dust-free and dry at installation.

### Earthquake safety

An earthquake can result in contact with the safety bearings. All forces occurring hereby are safely absorbed by the properly installed flange connections.

→ The vacuum chamber must be secured by the customer against shifting and tipping.

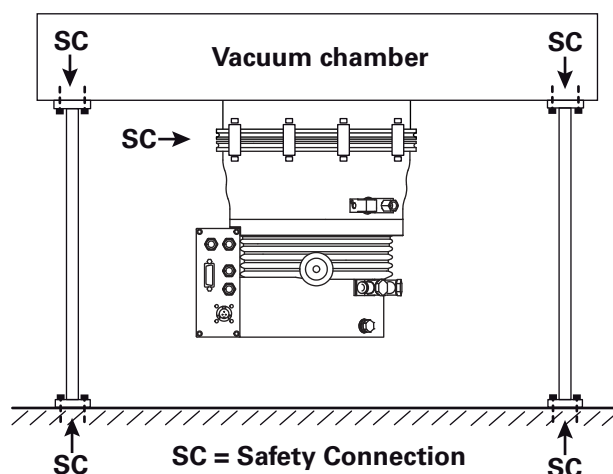

Fig. 3: Example: How to secure against shifting and tipping by external tremors

### Use of a splinter shield or protection screen

The installation of a Pfeiffer Vacuum centering ring with splinter shield or protection screen in the high vacuum flange protects the turbopump against foreign bodies coming from the chamber. The volume flow rate is reduced.

	Reduced pumping speed in %			
	H <sub>2</sub>	He	N <sub>2</sub>	Ar
Splinter shield DN 200	3	5	16	18
Protection screen DN 200	1	1	4	5

### Vibration damper



#### DANGER

#### Danger from the turbopump and vibration damper being torn-off

In case of sudden blocking of the rotor, an applied vibration damper cannot compensate any of the occurring forces. There is a danger of the turbopump being torn-off and thereby resulting severest injuries and property damages. Applicable safeguards must be taken to compensate possible occurring torques.

- Definitely consult with Pfeiffer Vacuum.
- Do not exceed the max. permissible temperature at the vibration damper (100° C).

### Mounting orientation

When using dry backing pumps Pfeiffer Vacuum HiPace pumps are designed for installation in any orientation.

- Support pipes in front of the vacuum pump or remove them. No force from the pipe system may be exerted on the fixed pump.
- To avoid contamination via the fore-vacuum line when using oil-sealed backing pumps the fore-vacuum flange should always point vertically downward ( $\pm 25^\circ$ ).

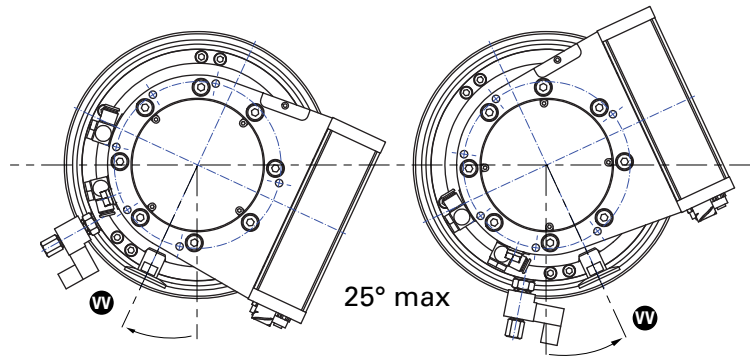

**Fig. 4: Recommended orientation of the fore-vacuum flange**

The maximum axial loading capacity of the high vacuum flange is 500 N (equals 50 kg). A one-sided load on the high vacuum flange is not permitted.

### Installing the high vacuum flange

If the rotor is suddenly blocked, the torques arising from the system and the high vacuum flange must be absorbed. Only the components designated as accessory can be used to fasten the turbo pumps to the high vacuum flange. The components for installing the turbo pumps are special designs of Pfeiffer Vacuum. Observe the minimum strength of 170 N/mm<sup>2</sup> for the flange material.



#### DANGER

##### Danger to life - impermissible fastening

Twisting or tearing-off is possible in case the rotor is suddenly blocked due to the fastening of pumps on a vacuum chamber with different flange variants.

- The combination of different flange types is impermissible in any case.
- Pfeiffer Vacuum will not accept any liability for all damages resulting from impermissible fastening.



#### NOTE

##### Observe shape tolerances for the counter flange!

Unevennesses of the customer supplied counter flange can lead to warping of the pump casing despite proper fastening. Leakiness and negative running characteristics can be the result.

- Do not exceed an evenness of max. 0.05 mm for the whole surface.



#### NOTE

##### Mounting of ISO flanges

If the rotor suddenly blocks the connection of high vacuum flanges of types ISO-KF or ISO-K can lead to twisting despite proper installation.

- The tightness of the high vacuum flange is not at risk thereby.

## Installation of ISO-K flange with ISO-K flange

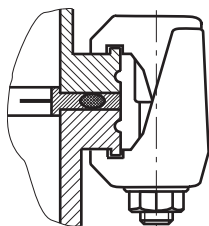

For the installation of the flange connections the following components are available:

- The valid mounting kit of the Pfeiffer Vacuum accessories programme.
  - A protection screen or splinter shield can optionally be used.
- Mind that the sealing surfaces are not damaged.
- Connect the flanges according to the drawing and with the component parts of the mounting kit.
- Use the required number of **8** claw clamps.
- Tighten the claw clamps crosswise in three steps.
- Tightening torque: 5, 15, 25 ±2 Nm

## Installation of ISO-F with ISO-F flange

The connection types for installation of ISO-F to ISO-F flange are "hex screw and blind hole", "stud screw and blind hole" as well as "stud screw and through hole". The following elements are required:

- The valid mounting kit of the Pfeiffer Vacuum accessories programme.
- A protection screen or splinter shield can optionally be used.

### Hexagon screw and blind hole

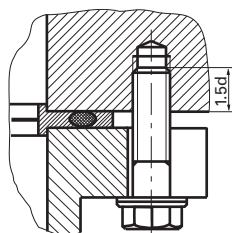

- Mind that the sealing surfaces are not damaged.
- Connect the flanges according to the drawing and with the component parts of the mounting kit.
- Use the required number of **12** hex screws with washer.
- For a flange material with a strength of > 270 N/mm<sup>2</sup> screw in the hex screw 1.5 d into the blind hole.
- Tighten the hex screws crosswise in three steps.
- Tightening torque DN 200: 10, 20, 38 ± 3 Nm

### Stud screw and blind hole

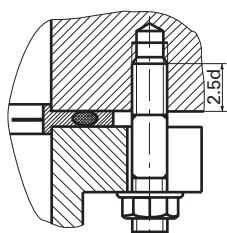

- Mind that the sealing surfaces are not damaged.
- Connect the flanges according to the drawing and with the component parts of the mounting kit.
- Use the required number of **12** stud screws and nuts.
- For a flange material with a strength of 170 - 270 N/mm<sup>2</sup> screw in the hex screw 2.5 d into the blind hole.
- Tighten the nuts crosswise in three steps.
- Tightening torque DN 200: 10, 20, 38 ± 3 Nm

### Stud screw and through hole

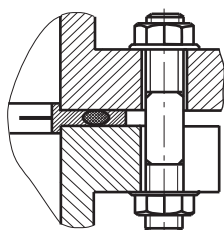

- Mind that the sealing surfaces are not damaged.
- Connect the flanges according to the drawing and with the component parts of the mounting kit.
- Use the required number of **12** stud screws and nuts.
- Tighten the nuts crosswise in three steps.
- Tightening torque DN 200: 10, 20, 38 ± 3 Nm

## Installation of CF-flanges



### NOTE

#### Preservation of sealing capacity

Observe the following to preserve sealing capacity:

- Touch seals only with gloves.
- Make sure sealing lips are undamaged.

The connection types for installation of CF to CF flange are "stud screw and blind hole" as well as "hex screw and through hole". The following elements are required:

- The valid mounting kit of the Pfeiffer Vacuum accessories programme.
- A copper seal
- A protection screen or splinter shield can optionally be used.

#### Stud screw and blind hole

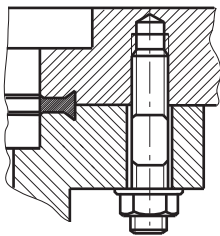

- If used: Insert protective screen or splinter shield with the clamping lugs downward into the high vacuum flange of the turbopump.
- Place the seal exactly in the hollow.
- Connect the flange using **24** stud screws (M8) with washers and nuts and tighten circularly with a torque of  $22 \pm 2$  Nm. After this, check the torque, since flowing of the sealing material may make it necessary to tighten the screws.

#### Hexagon screw and through hole

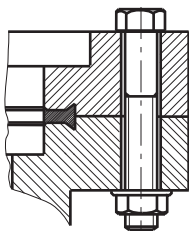

- If used: Insert protective screen or splinter shield with the clamping lugs downward into the high vacuum flange of the turbopump.
- Place the seal exactly in the hollow.
- Connect the flange using **24** hex screws (M8) with washers and nuts and tighten circularly with a torque of  $22 \pm 2$  Nm. After this, check the torque, since flowing of the sealing material may make it necessary to tighten the screws.

## 5.4 Connections to the turbopump

### Electronic drive unit

Turbopumps with integrated electronic drive unit are designed for various applications. Therefore different connection panels are available.

- TM 700 in standard version
- TM 700 PB for Profibus linking
- TM 700 E74 in dependence on specification SEMI E74
- TM 700 DN for DeviceNet linking

Detailed description for function, configuration and operation with the respective connection panel are given in the specific operating instructions for the electronic drive unit.

### Connecting the power supply

For voltage supply of the electronic drive unit TM 700, only use original power supplies (e.g. TPS 400 or DCU 400). Use of other power supplies only after consultation with Pfeiffer Vacuum. Connecting cables are available from the Pfeiffer Vacuum accessory programme.





**WARNING**

**Danger of electric shock**  
 In case of defect, the parts connected to the mains supply are under voltage.  
 → Always keep the mains connection freely accessible so you can disconnect it at any time.

→ Make sure that the turbopump has the correct supply voltage.

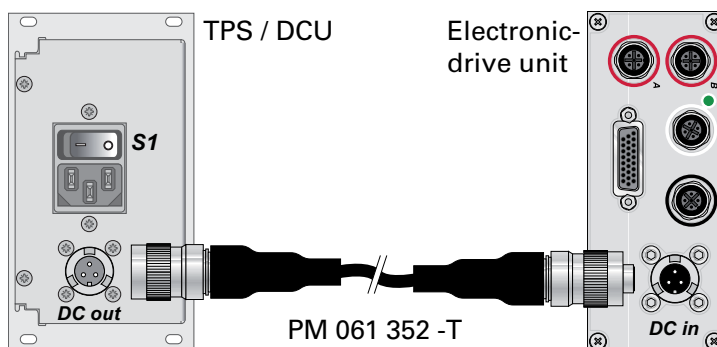
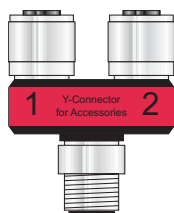

**Fig. 5: Connecting the TM 700 to a power supply pack using a Pfeiffer Vacuum cable**

- Switch off switch *S1* on the mains pack (position "0").
- Insert the connection cable with the socket in the connection "*DC in*" on the electronic drive unit and close the bayonet lock.
- Insert the connection cable with the plug in the connection "*DC out*" on the power supply and close the bayonet lock.

### Accessory connection

Up to 4 accessories can be connected to the electronic drive unit TM 700. M12 sockets with the designation "*accessory*" are available for this purpose. The accessory connections have been preconfigured at the factory. If the units listed below are connected with the preconfigured connection, they are immediately ready for operation according to the factory settings. It is possible to connect other accessories; to do so, settings must be made on the electronic drive unit.



- To connect two units to one accessory connection, use the appropriate Y-Connector from the Pfeiffer Vacuum range of accessories.
- Connect the adapter to the appropriate red-coded connection on the TM 700.
- Settings can be made via the interfaces of the TM 700 (*remote, RS485, Profibus or DeviceNet*).

Accessory connection	Connection with Y-connector	Preset accessory
<i>Accessory A1</i>	Acc. A to Y-1	Air cooling unit
<i>Accessory A2</i>	Acc. A to Y-2	Backing pump
<i>Accessory B1</i>	Acc. B to Y-1	Venting valve
<i>Accessory B2</i>	Acc. B to Y-2	Casing heating unit

**Overview of factory preset accessory connections on the TM 700**

### Venting valve

The Pfeiffer Vacuum venting valve is used for automatic venting in case of shutdown or power failure.

The permissible connection pressure is max. 1.5 bar absolute.

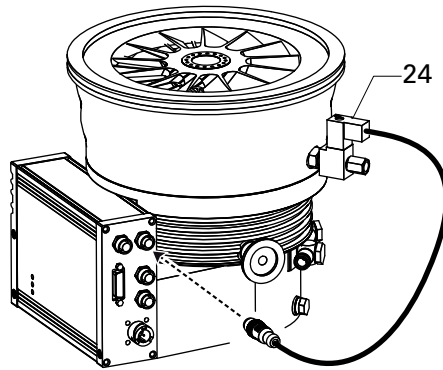

Fig. 6: Connecting the venting valve 24

- Plug in and fix the accessory's control lead to the corresponding accessory connection port on the TM 700.
- Default for the venting valve is "accessory B1".
- If necessary install a venting gas supply (e.g. inert gas) to the intake (G 1/8") of the solenoid valve.

**Connecting the fore-vacuum side**

**Recommendation:** As backing pump, use a dry-compressing vacuum pump or a rotary vane pump from the Pfeiffer Vacuum programme. The backing pump must generate a vacuum pressure of  $\leq 5$  mbar.



**WARNING**

**Damage to health due to poisonous gases**  
 Process gases can damage health and contaminate the environment.

- Safely lead away the gas emission from the backing pump!
- Observe all safety recommendations of the gas producer.

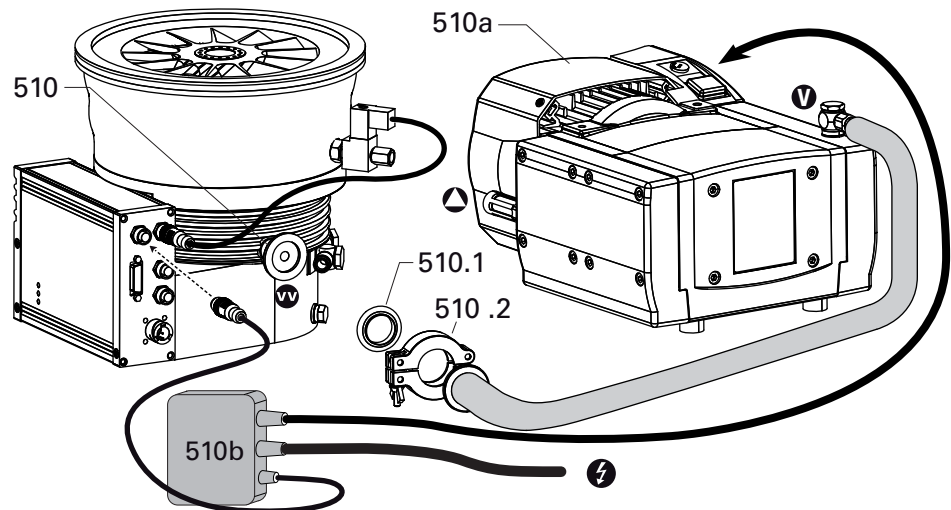

Fig. 7: Connecting the backing pump

- |                            |                             |                     |
|----------------------------|-----------------------------|---------------------|
| 510 Fore-vacuum connection | 510b Backing pump relay box | 510.2 Clamping ring |
| 510a Backing pump          | 510.1 Centering ring        |                     |



**NOTE**

**Design of the fore-vacuum connection regarding sudden twisting of the pump**  
 If the rotor suddenly blocks the connection of high vacuum flanges of types ISO-KF or ISO-K can lead to twisting despite proper installation.

- Keep masses small, which can be installed directly to the pump.
- First connect flexible line elements directly to the turbopump, if necessary.

- With rigid pipe connections: Install bellows for attenuation of vibrations in the connection line.
- Connect the fore-vacuum line with small-flange components or threaded hose couplings. Do not narrow the free cross section of the fore-vacuum flange!
- The backing pump is connected electrically via a relay box.
- Plug in and fix the accessory's control lead to the corresponding accessory connection port on the TM 700.
- Default for the backing pump is "accessory A2".
- Establish the mains supply for the relay box according to the accessory operating instructions.
  - Observe the valid supply voltage of the backing pump.

## Air cooling

As an option, turbopumps with the electronic drive unit TM 700 may be operated with air cooling up to an ambient temperature of +35 °C.

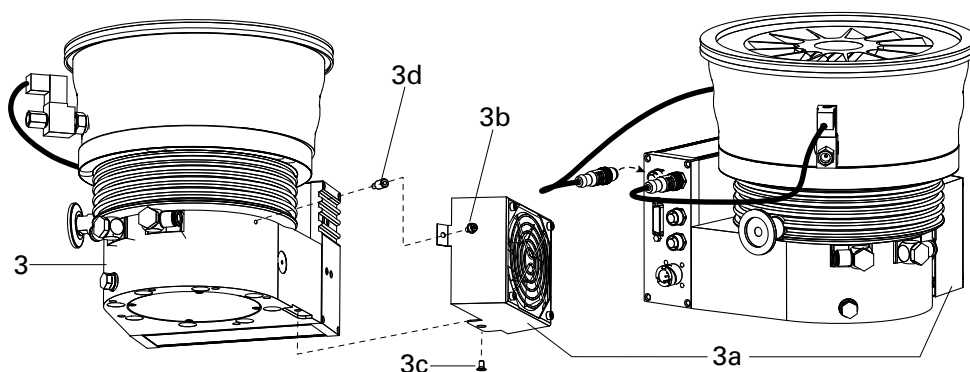

**Fig. 8: Connecting the air cooling**

3	Pump lower part	3b	Allen head screw	3d	Threaded adapter
3a	Air cooling unit	3c	Counter sunk screw		

- Insert the threaded adapter into the designated borehole of the pump lower part.
- Fix the Pfeiffer Vacuum air cooling unit to the holes of the turbopump and the threaded adapter using two screws.
- Plug in and fix the accessory's control lead to the corresponding accessory connection port on the TM 700.
- Default for air cooling is "accessory A1".

## Heating jacket

The turbopump and vacuum chamber can be heated to reach the final pressure more quickly. Use of a heating jacket is only permissible for pumps with the high vacuum flange in stainless steel design. The heating duration depends on the degree of contamination as well as the final pressure to be reached and should be at least 4 hours.



### CAUTION

#### Dangerous excess temperatures

Process-related high temperatures can result in impermissible excess temperatures and thus damage to the turbopump.

- Always use water cooling when a casing heating is used or when the pump is connected to a heated vacuum chamber.



**WARNING**

**Danger of burns**  
 High temperatures arise when the turbopump or vacuum chamber are baked out. As a result, there is a danger of burns from touching hot parts, even after the casing heating is switched off!

- Thermally insulate heating jacket, pump housing and vacuum chamber, if possible during installation.
- Do not touch heating jacket, pump casing and vacuum chamber during bake out.

- When using a casing heating and a water cooling unit the temperature of the connected flange of the vacuum chamber must not exceed 120 °C.
- The maximum permissible rotor temperature for the turbopump is 120 °C. If high temperatures arise for process reasons, the radiated heat input must not exceed 4.2 W. Install suitable screening sheets, if necessary (design information on request).

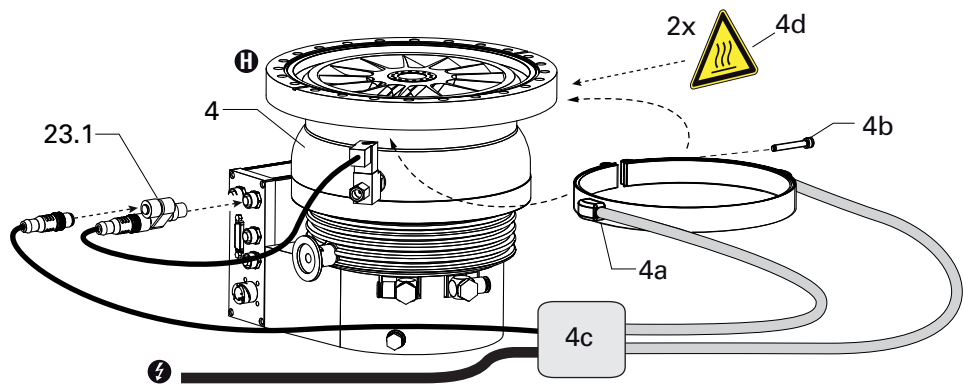

**Fig. 9: Connecting the heating jacket**

- |    |                |    |                   |      |                             |
|----|----------------|----|-------------------|------|-----------------------------|
| 4  | Pump casing    | 4b | Fixing screw      | 4d   | Warning sticker             |
| 4a | Heating jacket | 4c | Heating relay box | 23.1 | Y-Connector for accessories |

- Bend open the outer heating jacket on the tensioning strap and place it sideways on to the cylindrical segment of the pump casing.
  - Do not bend the heating straps!
  - The heating jacket must seat completely on the casing segment.
- Fix the heating jacket with the fixing screw on the casing.
  - Observe the tightening torque for the fixing screw!

Fixing screw	Tightening torque in cold condition	Tightening torque during the heating-up	Singular retightening after the cooling down
M5	6 Nm	7 Nm	7 Nm
M6	11 Nm	12 Nm	12 Nm

**Tightening torques for fixing screws of heating jackets**

- Plug in and fix the accessory's control lead to the corresponding accessory connection port on the TM 700.
  - In case of double assignment (e.g. by venting valve) use a Y-Connector of the accessories program.
- Default for the casing heating is "accessory B2".
- Establish the mains supply for the relay box according to the accessory operating instructions.
  - Observe the valid supply voltage of the backing pump.

**Sealing gas connection**

The turbopump must be operated with sealing gas to protect it, such as in the case of unclean processes or high gas throughput. The supply is made via a sealing gas valve or alternatively via a sealing gas throttle without control. The activation of the control valve for the sealing gas connection is not pre-installed in the electronic drive unit and has to be configured via their interfaces.

The permissible connection pressure is max. 1.5 bar absolute.

- When operating the pump with more than 50 % of the maximum gas throughput, sealing gas must be used to ensure rotor cooling.
- The sealing gas flow rate amounts 12-15 sccm for the HiPace 800 M.

### Sealing gas supply without control valve

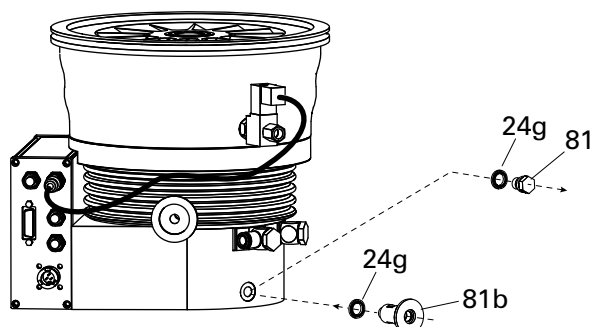
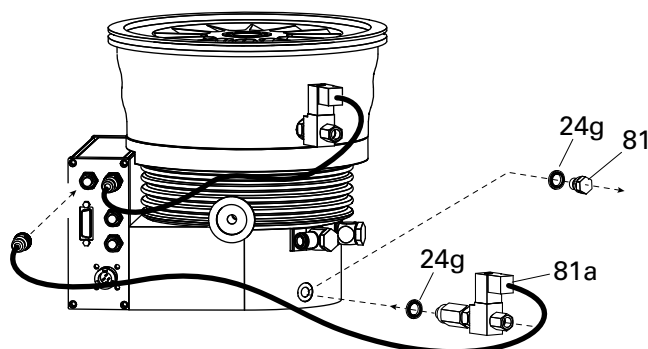

**Fig. 10: Connecting the sealing gas throttle**

24g Seal ring      81 Locking screw      81b Sealing gas throttle

- Unscrew the locking screw with seal ring out of the sealing gas connection.
- Screw the sealing gas throttle with sealing ring into the sealing gas connection.

### Sealing gas supply with control valve



**Fig. 11: Connecting the sealing gas valve**

24g Seal ring      81 Locking screw      81a Sealing gas valve

- Unscrew the locking screw with seal ring out of the sealing gas connection.
- Screw the sealing gas valve with seal ring into the sealing gas connection.
- Insert the control cable of the accessory into a free accessory connector on the TM 700 and tighten.
- Make the settings and control via the interfaces of the electronic drive unit.
- Install the sealing gas supply (e.g. inert gas) via a connection adapter or on the inlet side (G 1/8") of the control valve.

## Water cooling

The turbopumps HiPace 800 M with TM 700 have water cooling as standard equipment.

- In case of increased backing pressure (> 0.1 mbar) and/or operation with gas throughputs, either air or water cooling may be used.
- Generally use water cooling if the ambient temperature is > +35 °C.

### Cooling water requirements

Cooling water connection	Swiveling screw-fitting with plug and socket connection
Hose lines	External diameter 8 mm
	Internal diameter 6 mm
Cooling water quality	filtrated, mechanically clean, optically clear, no turbidity, no sediments, chemically neutral
Oxygen content max.	4 mg/kg
Chloride content max.	100 mg/kg
Water hardness max.	10 °dH
	12.53 °e
	17.8 °fH
	178 ppm CaCO <sub>3</sub>
Consumption of potassium permanganate max.	10 mg/kg
Carbon dioxide content max.	undetectable
Ammonia content max.	undetectable
pH-value	7 - 9
Fore-line overpressure max.	6 bar
Cooling water temperature	refer to "Technical Data"
Cooling water consumption at max. gas throughput	refer to "Technical Data"

### Connecting to a cooling water system

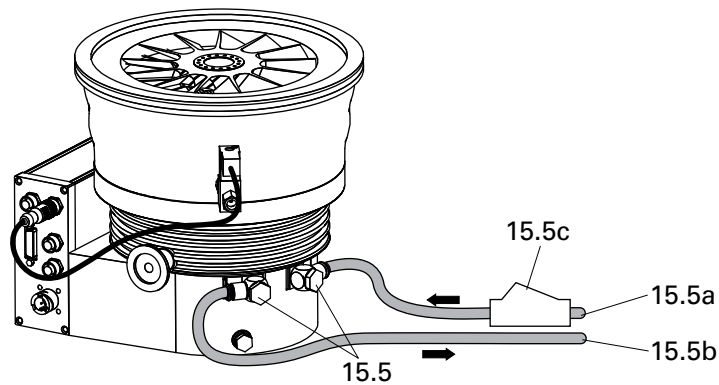

**Fig. 12: Connecting the cooling water**

15.5 Cooling water connection  
 15.5a Fore-line  
 15.5b Return line  
 15.5c Dirt trap

- Insert hoses for the water cooling fore- and return-line as far as they will go in one cooling water connection each.
- **Recommendation:** install dirt trap in the fore-line.
- Torque of the banjo fitting: 3 - 3.5 Nm.

## 6 Operation



### WARNING

#### Danger due to open high vacuum flange

The rotor of the turbopump turns at high speed. If the high vacuum flange is open, there is a danger of cut injuries and that the pump can be destroyed by objects falling into it.

→ Never operate the pump with an open high vacuum flange.



### NOTE

#### Low-maintenance operation

Safety bearings prevent contact between the rotor and stator in the event of magnetic bearing overload, making them subject to wear. Extend safety bearing service life by:

- Not subjecting running pumps to knocks, vibrations or position changes, particularly tilting movements.
- Avoiding sudden pressure fluctuations on the high-vacuum or pre-vacuum side during operation.
- Observing the maximum rate of pressure rise.
- Only aerating the pump via the venting valve supplied.
- Not switching off the pump by disconnecting the mains power supply.

### 6.1 Commissioning

The following important settings are programmed in the electronic drive unit ex factory.

- Parameter [P:027] Gas mode: 0 = heavy gases
  - Parameter [P:700] Set value max. run-up time monitoring: 8 min
  - Parameter [P:701] Rotation speed switchpoint: 80% of the nominal rotation speed
  - Parameter [P:707] Set value rotation speed setting mode 65 % of the nominal rotation speed
  - Parameter [P:708] Set value power consumption 100 %
  - Parameter [P:720] Venting rotation speed at delayed venting: 50% of the nominal rotation speed
  - Parameter [P:721] Venting time: 3600 s
- When water cooling is used: Open cooling water supply and check the flow.
- When sealing gas is used: Open the sealing gas supply and check the flow.
- Establish the mains for the power supply.

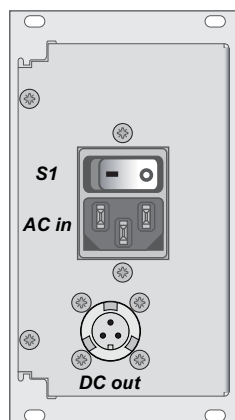
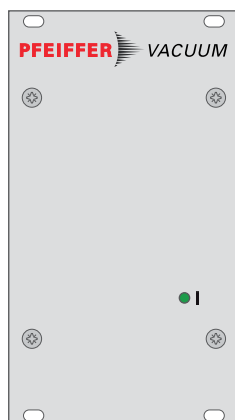

S1 Switch ON/OFF  
AC in Mains connection  
DC out Connection TM 700

Fig. 13: Front and rear view of a TPS mains pack



**CAUTION**

**Danger of the pump being destroyed**

Pumping of gases with a higher molecular mass in the wrong gas mode can lead to destruction of the pump.

- Ensure the gas mode is correctly set.
- Contact Pfeiffer Vacuum before using gases with a greater molecular mass (> 80).

**Magnetic bearing calibration**

In rare cases, the magnetic bearing sensors may trigger re-calibration on enabling of the drive electronics. This will result in regular metallic knocking noises, but is not connected to wear on the safety bearings.

**6.2 Operation modes**

The following operation modes are available:

- Operation via "remote" connection
- Operation via RS485 and Pfeiffer Vacuum display and control units or PC
- Operation via field bus

**6.3 Function description**

**Operation via "remote" connection**

Remote control options are provided via the 26-pole D-Sub connector with the designation "remote" on the electronic drive unit.

- Consider the following manuals for the operation via remote control:
  - Operating instructions "Electronic drive unit TM 700"

**Operation with DCU or HPU**

→ Consider the following manuals for the operation via Pfeiffer Vacuum display and control units:

- Operating instructions "DCU"
- Operating instructions "HPU"
- Operating instructions "Electronic drive unit TM 700"

→ Switch on the supply voltage with switch S1 on the power supply or on the DCU 400.

→ Settings are possible via the RS485 by using DCU, HPU or PC.

After operating voltage is applied, the TM 700 performs a self-test to check the supply voltage. Once the self test has been successfully completed on the TM 700, the turbopump and the backing pump - if connected - begin to operate.

**Operation via field bus**

Integrating and operating Pfeiffer Vacuum turbopumps in the customer's field bus system is possible for electronic drive units with a corresponding field bus panel.



- Consider the following manuals for the operation via field bus:
  - Operating instructions for the electronic drive unit with the respective connection panel

**6.4 Monitoring of the operation conditions**

**Operating mode display via LED**

LEDs in the front panel of the electronic drive unit show basic operating conditions of the turbopump. A differentiated malfunction and warning display is possible only for operation with DCU or HPU.



LED	Symbol	Steady OFF	Flashing (1/12 s active)	Blinking (1/2 s active)	Steady ON
Green		insufficient power supply	Pumping station "OFF" Rotation speed ≤ 1Hz	Pumping station "OFF" Rotation speed > 1 Hz	Pumping station "ON"
Yellow		no warning			Warning
Red		no malfunction			Malfunction

**Temperature monitoring**

The drive power is reduced in case of impermissible motor temperature or impermissibly high housing temperature. This can cause falling below the rotation speed switchpoint and so result in turning off the turbopump.

**Safety bearing stress**

The level of stress on the safety bearings is linked to the severity of the disruptive influences on the running rotor. The stress on the safety bearings is expressed as a percentage of the maximum possible stress due to the drive electronics and can be viewed via the RS 485 interface using the Pfeiffer Vacuum display and control unit or PC.

**Balance**

The magnetic bearing sensorics permanently monitor the current rotor balance. The balance is expressed as a percentage of the maximum possible rotor imbalance due to the drive electronics and can be viewed via the RS 485 interface using the Pfeiffer Vacuum display and control unit or PC.

**6.5 Switching off and venting**

**Switching off**

After the turbopump is switched off, it must be vented to avoid contamination due to particles streaming back from the fore-vacuum area.

- Close the fore-vacuum line: Switch off the backing pump or close a fore-vacuum valve.
- Switch off the turbopump on the control unit or via remote control.
- Venting (possibilities, see below)
- For water cooling: Shut off the water supply.

**Electrical brake**

The turbopump is equipped with an electric brake. It supports rapid deceleration of the rotor until standstill.

- Settings are possible via the RS485 by using DCU, HPU or PC.

**Emergency power supply**



<b>CAUTION</b>
<p><b>Increased wear and damage due to incorrect operation</b></p> <p>Active magnetic bearings require a constant power supply. The motor acts as a generator and supplies the drive electronics in the event of a power failure. Below a speed of approx. 6000 rpm, the kinetic energy of the rotor will no longer be sufficient to supply the magnetic bearings. The drive electronics will switch off completely. The rotor will run down audibly in the safety bearings.</p> <p>→ Do not switch off the pump by disconnecting the mains power supply.</p>

- The green LED on the drive electronics will flash.

## Emergency stop



### NOTE

#### Emergency stop

The turbopump must be brought into a safe state in the event of an emergency.

- Switch off turbopump using the optional brake and activated venting.
- Disconnect the power supply pack from the mains once the turbopump has come to a standstill.
  - If necessary, disconnect the power supply pack from the mains irrespective of the pump speed.
- Lock main power switches or switches in the higher level power supply unit and secure against being switched back on until the cause of the fault has been eliminated.

## Venting

### Clocked venting

The electronic drive unit controls the venting rate by clocking the venting valve. Thus the turbopump is always vented quickly and safely without magnetic bearing overload.

### Venting with Pfeiffer Vacuum Venting Valve



### CAUTION

#### Danger of wear or damage of the pump

Uncontrolled venting can lead to magnetic bearing overload and thus to safety bearing wear.

- Only vent the pump via the provided venting valve.
- Do not replace the Pfeiffer Vacuum venting valve by other venting units.
- It is recommended first to vent via the Pfeiffer Vacuum venting valve until a rotation speed of 6000 rpm, before using additional venting units.
- Observe the maximum permissible venting flow rate.

- Vent turbopump via the venting connection with oil-free, dry air or inert gas.
- Enable venting via the functions of the electronic drive unit.
- Settings are possible via the RS485 by using DCU, HPU or PC.

Venting rotation speed	Switch off the pumping station	Mains power failure <sup>1)</sup>
50% of the nominal rotation speed	Venting valve opens for 3600 s (1 h, works setting)	Venting valve opens for 3600 s (1 h, works setting)

<sup>1)</sup>When mains power is restored the venting procedure is aborted.

### Basic information for the rapid venting

Venting of the vacuum chamber in two steps. Ask for details on individual solutions from Pfeiffer Vacuum.

- Vent for 20 seconds at a rate of pressure rise of max. 15 mbar/s.
  - The valve cross section for the venting rate of 15 mbar/s must be adapted to the size of the vacuum chamber.
  - For small vacuum chambers, use the Pfeiffer Vacuum venting valve.
- Then vent with an additional venting valve of any desired size.

## 7 Maintenance / replacement



### WARNING

#### Contamination of parts and operating fluid by pumped media is possible.

Poisoning hazard through contact with materials that damage health.

- In the case of contamination, carry out appropriate safety precautions in order to prevent danger to health through dangerous substances.
- Decontaminate affected parts before carrying out maintenance work.



### NOTE

#### Disclaimer of liability

Pfeiffer Vacuum accepts no liability for personal injury or material damage, losses or operating malfunctions due to improperly performed maintenance. The liability and warranty entitlement expires.

### 7.1 Maintenance intervals and responsibilities

- Clean the turbopump externally with a lint-free cloth and little industrial alcohol.
- Replace electronic drive unit yourself.
- For all other cleaning, maintenance or repair work, please contact your Pfeiffer Vacuum service location.

### 7.2 Replacing the electronic drive unit

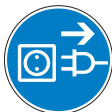

### CAUTION

#### Damages to the pump and drive

Even after the mains power is switched off, the subsequently running pump delivers electric power to the electronic drive unit. There is a danger of electric body contact by premature separating the pump from the electronic drive unit.

- Never separate the electronic drive unit from the pump when the mains power is connected or the rotor is running.



### NOTE

#### Operating parameters of the electronic drive unit

The factory operating parameters are always preset with replacement shipments.

- The use of a HPU enables the storing and the reuse of an existing parameter record.
- Reset any individually changed application parameters.
- Refer to the manual "Electronic drive unit".

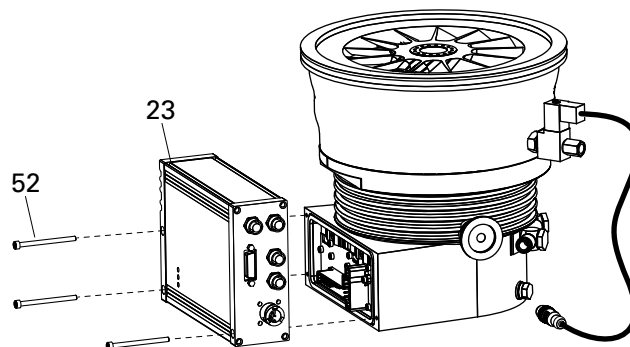

Fig. 14: Assembly / disassembly of the TM 700

23 Electronic drive unit      52 Allen head screw

- Do not exercise any mechanical load on the electronic drive unit.

- Turn off the vacuum pump, vent to atmospheric pressure and allow to cool, if necessary.
- Only separate the pump and the electronic drive unit from each other after disconnecting the supply voltage and the complete standstill of the pump.
- Remove the vacuum pump from the system, if necessary.
- Unscrew the venting valve control lead from the electronic drive unit.
- Unscrew Allen head screws (3x) from the electronic drive unit.
- Pull the electronic drive unit off the pump.
- Screw on and connect new electronic drive unit to the turbopump.
  - Tightening torque: **2.5 Nm**.

### Magnetic bearing calibration

In rare cases, the magnetic bearing sensors may trigger re-calibration on enabling of the drive electronics. This will result in regular metallic knocking noises, but is not connected to wear on the safety bearings.

### Rotation speed set value

The typical nominal rotation speed of a turbopump is factory-set in the electronic drive unit. If the electronic drive unit is replaced or a different pump type is used, the reference set value of the nominal rotation speed must be confirmed. This procedure is part of a redundant safety system for avoiding excess rotation speeds.

HiPace	Nominal rotation speed confirmation [P:777]
300	1000 Hz
400 / 700 / 800	820 Hz

- Adjust the parameter **[P:777]** according to the pump type.

## 8 Decommissioning

### 8.1 Shutting down for longer periods



#### WARNING

##### **Contamination of parts and operating fluid by pumped media is possible.**

Poisoning hazard through contact with materials that damage health.

- In the case of contamination, carry out appropriate safety precautions in order to prevent danger to health through dangerous substances.
- Decontaminate affected parts before carrying out maintenance work.

If the turbopump should be shut down for longer than a year:

- Remove the vacuum pump from the system, if necessary.
- Close the high vacuum flange of the turbopump.
- Evacuate turbopump via the fore-vacuum flange.
- Vent turbopump via the venting connection with oil-free, dry air or inert gas.
- Close the flange openings by using the original protective covers.
- Close further connection ports by using the corresponding protective covers.
- Place pump upright on rubber feet.
- Store the pump only indoors at temperatures between -25 °C and +55 °C.
- In rooms with moist or aggressive atmospheres, the pump must be airproof shrink-wrapped in a plastic bag together with a bag of desiccant.

### 8.2 Re-starting

- Check turbopump for contamination and moisture.
- Clean the turbopump externally with a lint-free cloth and little industrial alcohol.
- If necessary, have Pfeiffer Vacuum Service clean the turbopump completely.
- Installation and commissioning in accordance with the operating instructions.

### 8.3 Disposal

Products or parts thereof (mechanical and electrical components, operating fluids, etc.) may cause environmental burden.

- Safely dispose of the materials according to the locally applicable regulations.

## 9 Malfunctions

If malfunctions on the pump occur, you will find possible causes and instructions for repair in the following table.

### 9.1 Rectifying malfunctions

Problem	Possible causes	Remedy
Pump will not start; none of the built-in LEDs on the TM 700 lights up	• Electrical supply interrupted	⇒ Check plug contacts on the power supply ⇒ Check supply lines on the power supply ⇒ Check the output voltage (48 V DC) on the connection "DC out" of the power supply ⇒ Check the plug contacts on the TM 700
	• Operating voltage incorrect	⇒ Apply correct operating voltage ⇒ Observe the rating plate
	• No operating voltage applied	⇒ Apply operating voltage
	• TM 700 defective	⇒ Exchange the TM 700 ⇒ Contact the Pfeiffer Vacuum Service
Pump will not start; green LED on the TM 700 is flashing	• At operation without control panel: Pins 1-3, 1-4 or 1-14 are not connected on the "remote" connection	⇒ Connect the pins 1-3, 1-4 or 1-14 on the "remote" connection
	• At operation via RS485: Bridge at Pin 1-14 prevents control commands	⇒ Remove the bridge at the "remote" connection ⇒ Remove the mating plug from the "remote" connection.
	• At operation via RS485 (without counter plug): Parameters of the electronic drive unit not set	⇒ Set parameters [P: 010] and [P: 023] "ON" via interface RS485 <sup>1)</sup> . ⇒ Please refer to operating instructions of the electronic drive unit.
	• Voltage drop in the cable too high	⇒ Use a suitable cable
Pump does not attain the final rotational speed within the specified run-up time	• Fore-vacuum pressure too high	⇒ Ensure function and suitability of the backing pump
	• Leak	⇒ Perform leak detection ⇒ Check sealings and flange fastenings ⇒ Eliminate leaks
	• Gas throughput too high	⇒ Reduce process gas supply
	• Rotor runs hard, bearing defective	⇒ Check the bearing for noises ⇒ Check safety bearing stress via "RS 485" <sup>1)</sup> ⇒ Contact the Pfeiffer Vacuum Service
	• Setpoint for run-up time too low	⇒ Extend the run-up time via connection "RS 485" <sup>1)</sup>
	• Thermal overload: – Lack of air ventilation – Water flow too low – Fore-vacuum pressure too high – Ambient temperature too high	⇒ Reduce thermal loads – Ensure adequate cooling – Ensure the cooling water flow – Lower the fore-vacuum pressure – Adjust ambient conditions
Pump does not attain the ultimate pressure	• Pump is dirty	⇒ Bake out the pump ⇒ Cleaning in case of heavy contamination – Contact the Pfeiffer Vacuum Service
	• Vacuum chamber, pipes or pump are leaky	⇒ Leak detection starting from the vacuum chamber ⇒ Eliminate leaks
Red LED on the TM 700 is on	• Collective fault	⇒ Reset by switching the mains OFF/ON ⇒ Reset via pin 13 on the "REMOTE" connection ⇒ Differentiated malfunction display is possible via "RS 485" <sup>1)</sup> ⇒ Contact the Pfeiffer Vacuum Service

<sup>1)</sup>If no Pfeiffer Vacuum display and control unit is available, please contact the Pfeiffer Vacuum Service.

## 10 Service

### **Pfeiffer Vacuum offers first-class service!**

- Maintenance / repair in the nearby ServiceCenter or ServicePoint
- Fast replacement with exchange products in mint condition
- Advice on the most cost-efficient and quickest solution

Detailed information, addresses and forms at: [www.pfeiffer-vacuum.com](http://www.pfeiffer-vacuum.com) (**Service**).

### **Maintenance and repair in the Pfeiffer Vacuum ServiceCenter**

The following steps are necessary to ensure a fast, smooth servicing process:

- Download the forms "Service Request" and "Declaration on Contamination".<sup>1)</sup>
- Fill out the "Service Request" form and send it by fax or e-mail to your
- Pfeiffer Vacuum service address.
- Include the confirmation on the service request from Pfeiffer Vacuum with your shipment.
- Fill out the declaration on contamination and include it in the shipment (required!).
- Dismantle all accessories.
- Leave electronic drive on the pump.
- Close the flange openings by using the original protective covers.
- If possible, send pump or unit in the original packaging.

### **Sending of contaminated pumps or devices**

No units will be accepted if they are contaminated with micro-biological, explosive or radioactive substances. "Hazardous substances" are substances and compounds in accordance with the hazardous goods directive (current version). If pumps are contaminated or the declaration on contamination is missing, Pfeiffer Vacuum performs decontamination at the shipper's expense.

- Neutralise the pump by flushing it with nitrogen or dry air.
- Close all openings airtight.
- Seal the pump or unit in suitable protective film.
- Return the pump/unit only in a suitable and sturdy transport container and send it in while following applicable transport conditions.

### **Exchange unit**

The factory operating parameters are always preset with exchange units. If you use changed parameters for your application, you have to set these again.

### **Service orders**

All service orders are carried out exclusively according to our repair conditions for vacuum units and components.

<sup>1)</sup> Forms under [www.pfeiffer-vacuum.com](http://www.pfeiffer-vacuum.com)

## 11 Spare parts HiPace 800 M

Item	Designation	Size	Order number	Notes	Pieces	Order qty.
15.5	Swiveling screw-fitting		P 4131 007 E	water cooling unit	2	
23	Electronic drive unit TM 700		according to the rating plate	depends on the connection panel	1	
24	Venting valve		PM Z01 291	incl. seal ring	1	

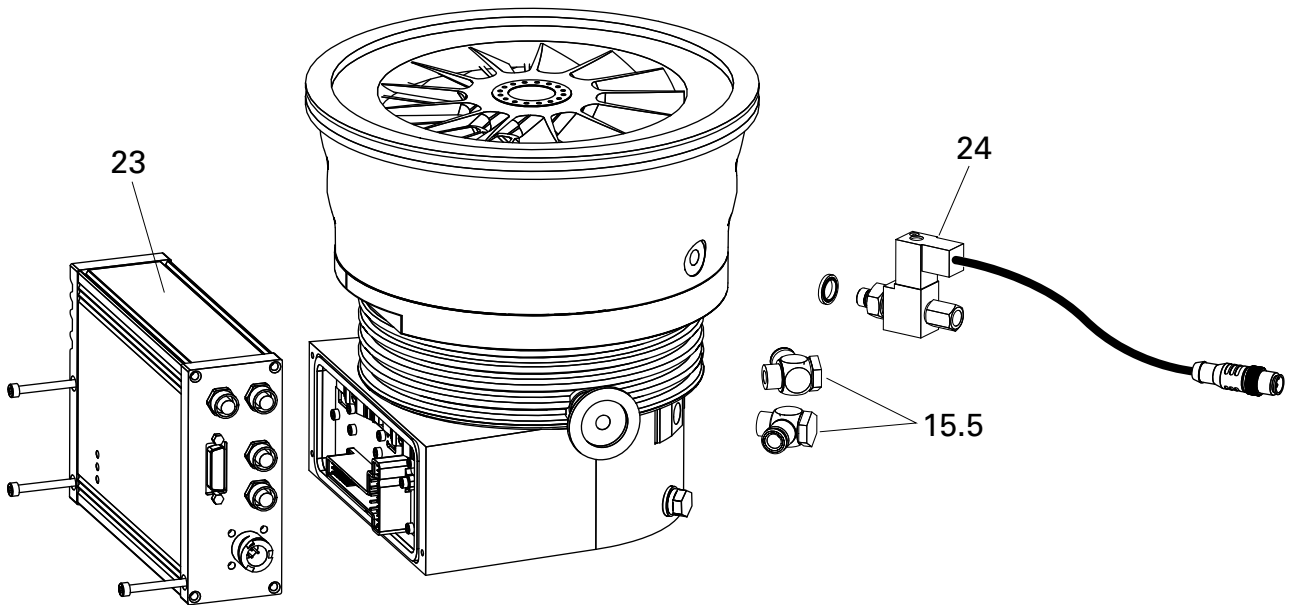

Please also specify model number of the the rating plate when ordering accessories or spare parts.



## 12 Accessories

Designation	DN 200 ISO-K	DN 200 CF-F	DN 200 ISO-F
TPS 400, mains pack for wall/standard rail fitting	PM 061 343-T	PM 061 343-T	PM 061 343-T
Wall rail fitting TPS 110/180/310/400	PM 061 392 -T	PM 061 392 -T	PM 061 392 -T
TPS 401, mains pack 19" rack module 3 RU	PM 061 347-T	PM 061 347-T	PM 061 347-T
Front panel kit for TPS 401	PM 061 396 -T	PM 061 396 -T	PM 061 396 -T
DCU 400, Display control unit incl. power supply	PM C01 823	PM C01 823	PM C01 823
DCU 002, Display control unit	PM 061 348-T	PM 061 348-T	PM 061 348-T
HPU 001, handheld programming unit	PM 051 510-T	PM 051 510-T	PM 051 510-T
Accessories package for HPU - Power supply, software and PC cable	PM 061 005-T	PM 061 005-T	PM 061 005-T
230 V AC mains cable with Euro-style safety plug, IEC power socket (straight), 3 m	P 4564 309 ZA	P 4564 309 ZA	P 4564 309 ZA
115 V AC mains cable with UL plug, IEC power socket (straight), 3 m	P 4564 309 ZE	P 4564 309 ZE	P 4564 309 ZE
208 V AC mains cable with UL plug, 3 m	P 4564 309 ZF	P 4564 309 ZF	P 4564 309 ZF
Connection cable for linking HiPace with TC 400 to power supply TPS/DCU 310/311/400/401	PM 061 352-T	PM 061 352-T	PM 061 352-T
24 V DC venting valve, G 1/8", for connection to TC 400/1200	PM Z01 291	PM Z01 291	PM Z01 291
TTV 001, air drier for venting turbopumps	PM Z00 121	PM Z00 121	PM Z00 121
Venting flange, DN 10 KF, G1/8"	PM 033 737 -T	PM 033 737 -T	PM 033 737 -T
Angled screw coupling for venting valve	PM 143 877 -T	PM 143 877 -T	PM 143 877 -T
Air cooling for HiPace 400 and HiPace 700 with TC 400	PM Z01 303	PM Z01 303	PM Z01 303
Heating jacket for HiPace 400 / 700 with TC 400 / TCP 350, 230 V AC, Euro-style safety plug		PM 061 369-T	
Heating jacket for HiPace 400 / 700 with TC 400 / TCP 350, 208 V AC, UL plug		PM 061 370-T	
Heating jacket for HiPace 400 / 700 with TC 400 / TCP 350, 115 V AC, UL plug		PM 061 371-T	
Backing pump relay box, single phase 5 A, for TC 400/1200	PM 061 374-T	PM 061 374-T	PM 061 374-T
Backing pump relay box, single phase 20 A, for TC 400/1200, TCP 350 and TM 3000	PM 061 375-T	PM 061 375-T	PM 061 375-T
TVV 001 fore-vacuum safety valve, 230 V AC	PM Z01 205	PM Z01 205	PM Z01 205
TVV 001 fore-vacuum safety valve, 115 V AC	PM Z01 206	PM Z01 206	PM Z01 206
Sealing gas valve for HiPace 300, 400 and 700 with TC 400	PM Z01 312	PM Z01 312	PM Z01 312
Sealing gas throttle for HiPace 300,400 and 700	PM Z01 317	PM Z01 317	PM Z01 317
Centering ring, with multifunction coating, DN 200 ISO-K/-F	PM 016 220-U		PM 016 220-U
Centering ring, with multifunction coating and integrated protection screen, DN 200 ISO-K/-F	PM 016 222-U		PM 016 222-U
Centering ring, with multifunction coating and integrated splinter shield, DN 200 ISO-K/-F	PM 016 221-U		PM 016 221-U
Protection screen for Turbopumps, DN 200 CF-F		PM 016 342	
Splinter screen, DN 200 CF-F		PM 016 321	
Vibration damper for HiPace 1200 and HiPace 1800, DN 200 ISO-K	PM 006 668-X		
Vibration damper for HiPace 1200, DN 200 CF-F		PM 006 669-X	
USB converter to RS-485 interface	PM 061 207-T	PM 061 207-T	PM 061 207-T
Interface cable, 3 m, M12	PM 061 283-T	PM 061 283-T	PM 061 283-T
Interface cable RS-485, 3 m, M12, straight, 90°	PM 061 791 -T	PM 061 791 -T	PM 061 791 -T
Y-Connector M12 to RS-485	P 4723 010	P 4723 010	P 4723 010
Y-Connector M12 for accessories	P 4723 012	P 4723 012	P 4723 012
Remote mating plug, HD26-pole without bridges	PM 061 986 -X	PM 061 986 -X	PM 061 986 -X
Power supply plug TC 400, straight	P 4723 100	P 4723 100	P 4723 100
Power supply plug TC 110, angled	P 4723 101	P 4723 101	P 4723 101
Enclosure for plug, spraywater-protected, 15-pole, D-Sub	P 0998 016	P 0998 016	P 0998 016
Remote plug, water resistant, 26-pole, HD	PM 061 880 -T	PM 061 880 -T	PM 061 880 -T
Remote adapter for RS-485	PM 061 649 -T	PM 061 649 -T	PM 061 649 -T
Connection cable, plug M12, RJ 45, 3 m	PM 051 726-T	PM 051 726-T	PM 051 726-T
Power supply plug TPS 110/180/310/400 DC out	P 4723 102	P 4723 102	P 4723 102
Extension cable for accessory M12 on M12	PM 061 747 -T	PM 061 747 -T	PM 061 747 -T
Round plug M12	P 4722 605	P 4722 605	P 4722 605

Designation	DN 200 ISO-K	DN 200 CF-F	DN 200 ISO-F
Mounting kit for HiPace 1200, DN 200 ISO-K, including coated centering ring, bracket screws	PM 016 390-T		
Mounting kit for HiPace 1200, DN 200 ISO-K, including coated centering ring, protection screen, clamping screws	PM 016 392-T		
Mounting kit for HiPace 1200, DN 200 ISO-K, including coated centering ring, splinter shield, bracket screws	PM 016 391-T		
Set of hexagonal bolts, 24 count, M8, DN 200 CF		PM 016 687-T	
Set of stud screws, 24 count, M8, DN 200 CF		PM 016 688-T	
Mounting kit for HiPace 1200 and HiPace 1800, DN 200 ISO-F, including coated centering ring, hexagon screws			PM 016 470-T
Mounting kit for HiPace 1200 and HiPace 1800, DN 200 ISO-F, including coated centering ring, protection screen, hexagon screws			PM 016 472-T
Mounting kit for HiPace 1200 and HiPace 1800, DN 200 ISO-F, including coated centering ring, splinter shield, hexagon screws			PM 016 471-T
Mounting kit for HiPace 1200 and HiPace 1800, DN 200 ISO-F, including coated centering ring, stud screws			PM 016 475-T
Mounting kit for HiPace 1200 and HiPace 1800, DN 200 ISO-F, including coated centering ring, protection screen, stud screws			PM 016 477-T
Mounting kit for HiPace 1200 and HiPace 1800, DN 200 ISO-F, including coated centering ring, splinter shield, stud screws			PM 016 476-T

## 13 Technical data and dimensions

### 13.1 General

Basic principles for the Technical Data of Pfeiffer Vacuum Turbopumps:

- Recommendations of PNEUROP committee PN5
- ISO 21360; 2007: "Vacuum technology - Standard methods for measuring vacuum-pump performance - General description"
- ISO 5302; 2003: "Vacuum technology - Turbomolecular pumps - Measurement of performance characteristics"
- Ultimate pressure: using a test dome and a 48 hrs. period of baking out
- Gas throughput: water cooling; backing pump = rotary vane pump (10 m<sup>3</sup>/h)
- Cooling water consumption: at max. gas throughput, cooling water temp. 25 °C
- Integral leak rate: using a Helium concentration of 100 %, period 10 s
- Sound pressure level: Distance 1 m to the pump

### 13.2 Technical data

Parameter	HiPace™ 800 M	HiPace™ 800 M	HiPace™ 800 M
Flange (in)	DN 200 ISO-K	DN 200 CF-F	DN 200 ISO-F
Flange (out)	25 ISO-KF	25 ISO-KF	25 ISO-KF
Pumping speed for Ar	775 l/s	775 l/s	775 l/s
Pumping speed for H <sub>2</sub>	500 l/s	500 l/s	500 l/s
Pumping speed for He	625 l/s	625 l/s	625 l/s
Pumping speed for N <sub>2</sub>	790 l/s	790 l/s	790 l/s
Compression ratio for Ar	> 1 · 10 <sup>11</sup>	> 1 · 10 <sup>11</sup>	> 1 · 10 <sup>11</sup>
Compression ratio for H <sub>2</sub>	2 · 10 <sup>5</sup>	2 · 10 <sup>5</sup>	2 · 10 <sup>5</sup>
Compression ratio for He	> 1 · 10 <sup>7</sup>	> 1 · 10 <sup>7</sup>	> 1 · 10 <sup>7</sup>
Compression ratio for N <sub>2</sub>	> 1 · 10 <sup>11</sup>	> 1 · 10 <sup>11</sup>	> 1 · 10 <sup>11</sup>
Gas throughput at 0.1 mbar HV for Ar	16 mbar l/s	16 mbar l/s	16 mbar l/s
Gas throughput at 0.1 mbar HV for H <sub>2</sub>	9 mbar l/s	9 mbar l/s	9 mbar l/s
Gas throughput at 0.1 mbar HV for He	16 mbar l/s	16 mbar l/s	16 mbar l/s
Gas throughput at 0.1 mbar HV for N <sub>2</sub>	16 mbar l/s	16 mbar l/s	16 mbar l/s
Gas throughput at full rotational speed for Ar	8 mbar l/s	8 mbar l/s	8 mbar l/s
Gas throughput at full rotational speed for N <sub>2</sub>	13 mbar l/s	13 mbar l/s	13 mbar l/s
Fore vacuum max. for N <sub>2</sub>	8 mbar	8 mbar	8 mbar
Run-up time	4 min	4 min	4 min
Ultimate pressure with OnTool™ DryPump	< 1 · 10 <sup>-7</sup> mbar	< 5 · 10 <sup>-10</sup> mbar	< 1 · 10 <sup>-7</sup> mbar
Rotation speed ± 2 %	49200 min <sup>-1</sup>	49200 rpm	49200 rpm
Rotation speed: variable	20-100 %	20-100 %	20-100 %
Sound pressure level	≤ 45 dB (A)	≤ 45 dB (A)	≤ 45 dB (A)
Relative humidity of air	5-85, non- condensing %	5-85, non- condensing %	5-85, non- condensing %
Protection category	IP 54	IP 54	IP 54
Connection pressure max. for venting/sealing gas valve	1.5 bar	1.5 bar	1.5 bar
Operating voltage	48 (± 5 %) V DC	48 (± 5 %) V DC	48 (± 5 %) V DC
Operating voltage power supply	90-265 V AC	90-265 V AC	90-265 V AC
Integral leak rate	< 1 · 10 <sup>-7</sup> mbar l/s	< 1 · 10 <sup>-7</sup> mbar l/s	< 1 · 10 <sup>-7</sup> mbar l/s
Power consumption max.	300 W	300 W	300 W
Current consumption max.	7.5 A	7.5 A	7.5 A
Shipping and storage temperature	0-+55 °C	0-+55 °C	0-+55 °C
Venting connection	G 1/8"	G 1/8"	G 1/8"
Weight	17.2 kg	21.6 kg	18 kg
Cooling method, standard	Water	Water	Water
Cooling method, optional	Air, Convection	Air, Convection	Air, Convection
Cooling water temperature	15-35 °C	15-35 °C	15-35 °C
Cooling water consumption	80 l/h	80 l/h	80 l/h
Permissible magnetic field max.	5 mT	5 mT	5 mT

Technical data and dimensions

---

<b>Parameter</b>	<b>HiPace™ 800 M</b>	<b>HiPace™ 800 M</b>	<b>HiPace™ 800 M</b>
Interfaces	RS-485, Remote	RS-485, Remote	RS-485, Remote

### 13.3 Dimensions

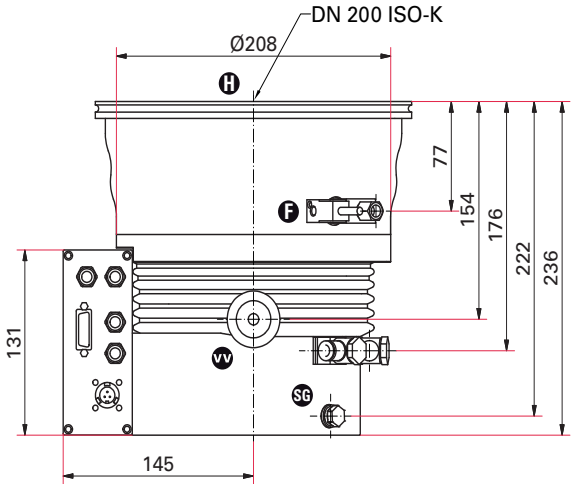
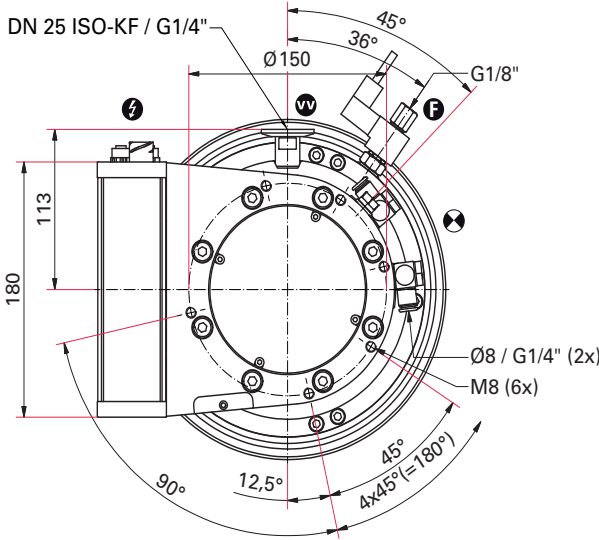

Fig. 15: HiPace 800 M, DN 200 ISO-K

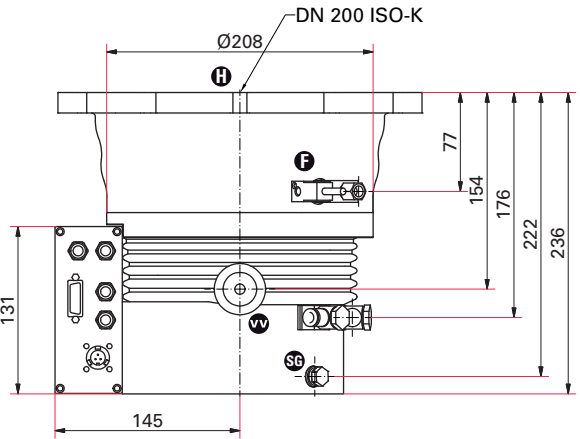
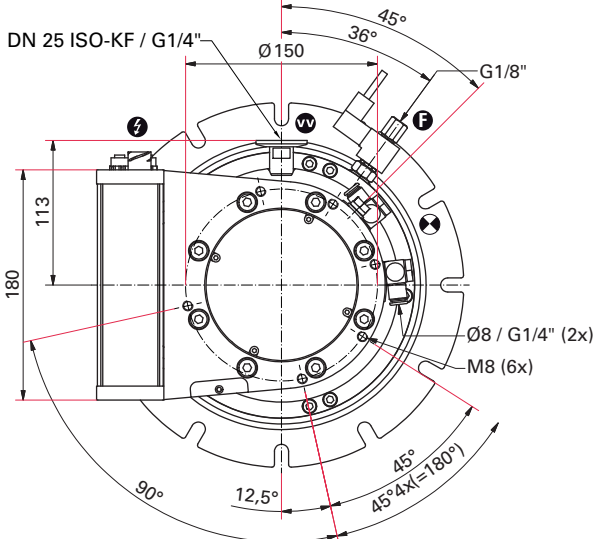

Fig. 16: HiPace 800 M, DN 200 ISO-F

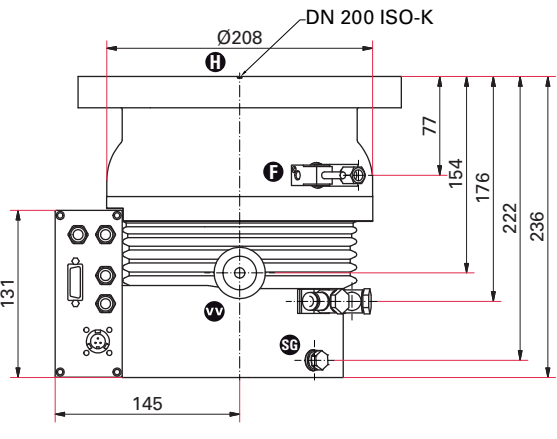
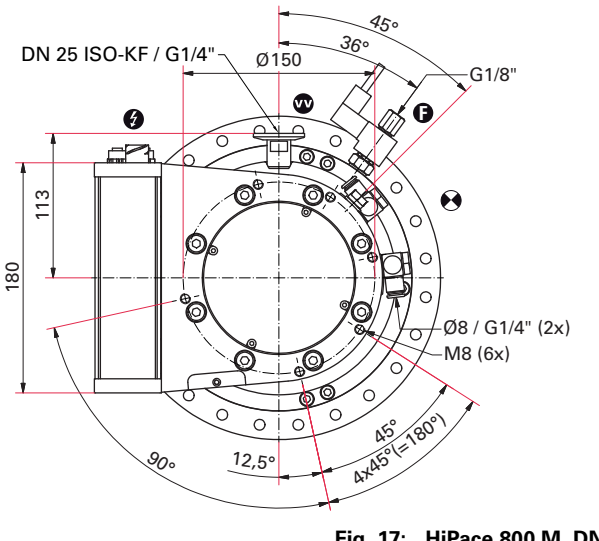

Fig. 17: HiPace 800 M, DN 200 CF-F



# Declaration of conformity

according to the EC directive:

- **Machinery 2006/42/EC (Annex II, no. 1 A)**

We hereby declare that the product cited below satisfies all relevant provisions of EC directive "Machinery" **2006/42/EC**.

In addition, the product cited below satisfies all relevant provisions of EC directive "Electromagnetic Compatibility" **2004/108/EC**.

The agent responsible for compiling the technical documentation is Mr. Jörg Stanzel, Pfeiffer Vacuum GmbH, Berliner Straße 43, 35614 Asslar.

## HiPace 800 M

Guidelines, harmonised standards and national standards and specifications which have been applied:

DIN EN ISO 12100 : 2011-03

DIN EN 1012-2 : 1996

DIN EN 61010-1 : 2002

Signatures:

Pfeiffer Vacuum GmbH  
Berliner Straße 43  
35614 Asslar  
Germany

---

(M. Bender)  
Managing Director

(Dr. M. Wiemer)  
Managing Director

CE/2011

**Leading. Dependable.  
Customer Friendly**

Pfeiffer Vacuum stands for innovative and custom vacuum solutions worldwide. For German engineering art, competent advice and reliable services.

Ever since the invention of the turbopump, we've been setting standards in our industry. And this claim to leadership will continue to drive us in the future.

**You are looking for a  
perfect vacuum solution?  
Please contact us:**

**Germany**

Pfeiffer Vacuum GmbH  
Headquarters  
Tel.: +49 (0) 6441 802-0  
info@pfeiffer-vacuum.de

**Benelux**

Pfeiffer Vacuum GmbH  
Sales & Service Benelux  
Tel.: +800-pfeiffer  
benelux@pfeiffer-vacuum.de

**China**

Pfeiffer Vacuum  
(Shanghai) Co., Ltd.  
Tel.: +86 21 3393 3940  
info@pfeiffer-vacuum.cn

**France**

Pfeiffer Vacuum France SAS  
Tel.: +33 169 30 92 82  
info@pfeiffer-vacuum.fr

**Great Britain**

Pfeiffer Vacuum Ltd.  
Tel.: +44 1908 500600  
sales@pfeiffer-vacuum.co.uk

**India**

Pfeiffer Vacuum India Ltd.  
Tel.: +91 40 2775 0014  
pfeiffer@vsnl.net

**Italy**

Pfeiffer Vacuum Italia S.p.A.  
Tel.: +39 02 93 99 05 1  
contact@pfeiffer-vacuum.it

**Korea**

Pfeiffer Vacuum Korea Ltd.  
Tel.: +82 31 266 0741  
sales@pfeiffer-vacuum.co.kr

**Austria**

Pfeiffer Vacuum Austria GmbH  
Tel.: +43 1 894 17 04  
office@pfeiffer-vacuum.at

**Sweden**

Pfeiffer Vacuum Scandinavia AB  
Tel.: +46 8 590 748 10  
sales@pfeiffer-vacuum.se

**Switzerland**

Pfeiffer Vacuum (Schweiz) AG  
Tel.: +41 44 444 22 55  
info@pfeiffer-vacuum.ch

**United States**

Pfeiffer Vacuum Inc.  
Tel.: +1 603 578 6500  
contact@pfeiffer-vacuum.com